



Nemo Shower-toilet chair



5100 5100

Nemo tilting Shower-toilet chair



For mobile people and people needing help



5100 5100

Nemo tilting Shower-toilet chair

The Lopital Nemo is a mobile tilting shower-toilet chair, which has been developed to give both user and carer maximum security and support during the showering and personal care process. In combination with a bedpan, bucket or toilet, the Nemo can also be used as a toilet chair.

The Nemo consists of a frame and a chair. The chair has the same comfort as a normal chair and offers the same correct support. It can be infinitely tilted to 30 degrees from the frame by means of a gas spring. This means the Nemo can be used for multifunctional purposes.

The Nemo is supplied standard with a head/neck support which can be adjusted in both height and depth. The chair has straight, independently foldable arm rests and the ergonomically shaped foot supports are foldable and removable.

- Maximum weight 150 kg.
- Frame width 66 cm, depth 73 cm.
- Infinite tilting by means of a gas spring, up to a maximum of 30 degrees.
- Upholstered seat with toilet opening.
- Inlay for the toilet opening.
- Foldable upholstered armrests for sideways transfer.
- Ergonomically formed seat and backrests.
- Head / neck support adjustable in height and depth.
- Fold-out footrests with calf protection.
- Fold-away and removable legrests.
- Rail for toilet bucket or bedpan.
- Four plastic castors, fitted with brakes.

Options

- Product no. 6950 1104 Commode pan and lid.
- Product no. 6840 5660 Armrests with front lock.
- Product no. 6975 8044 Hip belt with plastic fastener.
- Product no. 6975 8045 4 point safety belt.
- Product no. 6960 8026 Comfortable leg support, adjustable in 3 settings.
- Product no. 7500 5693 Raising set 10 mm. to max. 30 mm.



Option: Product no. 6960 8026 Comfort leg support.



Easy to operate by means of the control handle.



Gas spring for the infinite adjustment of the shower-toilet chair.



Option: Product no. 6950 1104
Commode pan.



Option: Product no. 6840 5660
Foldable upholstered armrests with front lock.



Standard equipped with a head / neck support. Adjustable in height and depth.



Fold-away and removable legrests.



Normal position.



Tilting function up to 30° backwards.

Technical specifications

• Seat width	47 cm / 18.5 inch	• Total length basic frame	73 cm / 28.7 inch
• Seat depth	44 cm / 17.3 inch	• Total width basic frame	66 cm / 18.5 inch
• Seat height	54 cm / 21.3 inch	• Own weight	24,5 kg / 54 lbs
• Max. load	150 kg / 330.7 lbs	• Head support adjustment	Depth 7 cm / 2.8 inch & height 12 cm / 4.7 inch
• Tilt	0° to 30° backwards		

The Nemo is a class 1 product with CE-marking. This marking corresponds with directive 93/42/EC and the revised directive 2007/47/EC for medical devices of 21 March 2010. Our hygiene products comply with ISO 17966 Assistive products for personal hygiene.

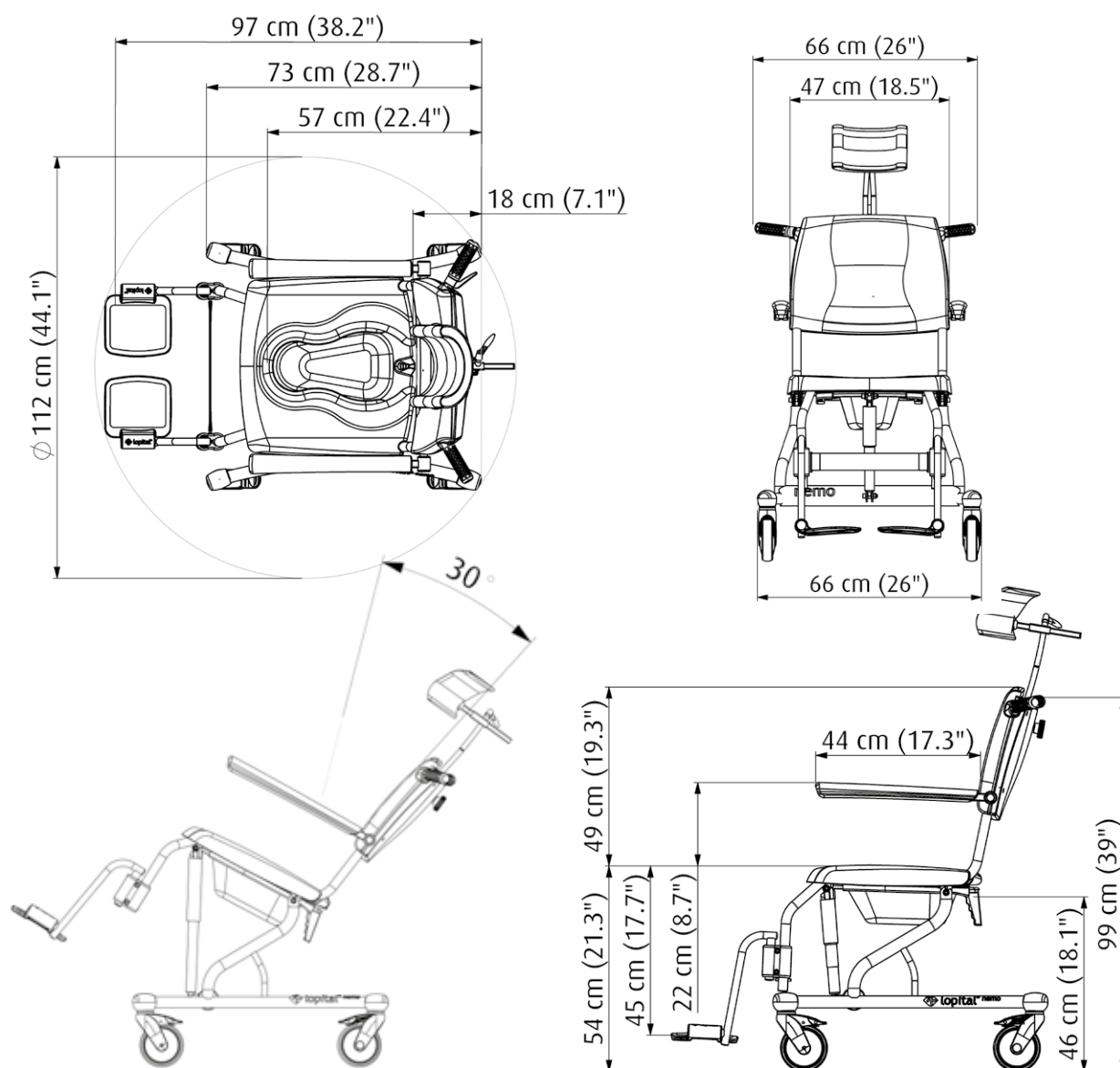

For more information, visit our website: www.lopital.com

Lopital Nederland B.V., Laarakkerweg 9, 5061 JR Oisterwijk, Postbus 56, 5060 AB Oisterwijk
 Tel +31 (0)13 5239300, Fax +31 (0)13 5239301, E-mail info@lopital.nl, www.lopital.nl

ISO 9001

ISO 13485

